



# Take a test at home!



Taking the Oxford Placement Test  
at home is easy!

Just follow these steps.

# Okay, let's get started.

## Step 1: Check your equipment

- You need an internet connection.
- You need a good pair of headphones
- Your device must meet the minimum system requirements. To check these, click here: [system requirements](#). Then, click on '**automatic system check**'.

### System requirements

In order to ensure you have the best test experience, please make sure your device can meet these system requirements

#### Automatic system check

Run our **automatic system check**. This will tell you whether your computer can show our online materials and play the audio for listening questions.

## Step 2: Sign in

Sign in using the information that was sent to you by email.

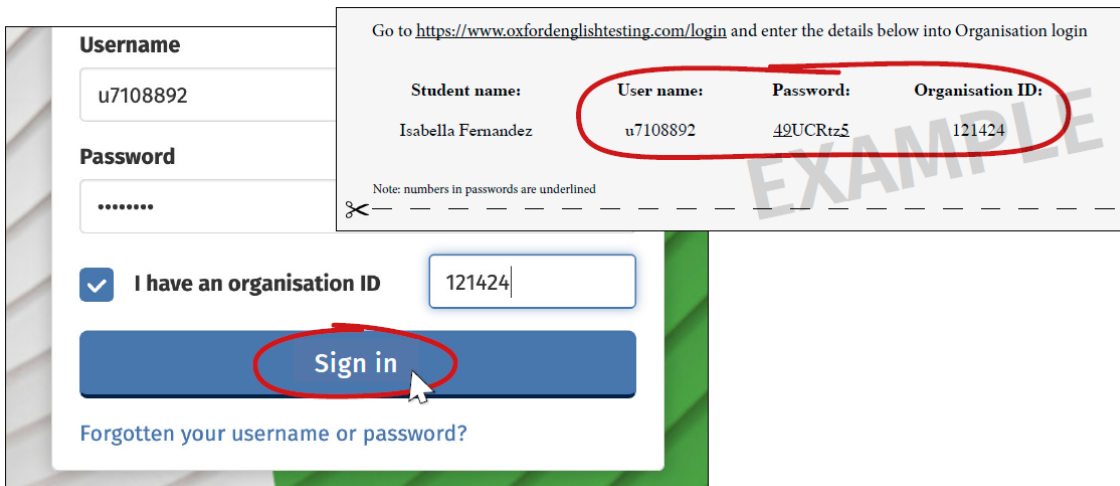

Go to <https://www.oxfordenglishtesting.com/login> and enter the details below into Organisation login

Student name:	User name:	Password:	Organisation ID:
Isabella Fernandez	<u>u7108892</u>	<u>49UCRtz5</u>	121424

Note: numbers in passwords are underlined

I have an organisation ID

**Sign in**

[Forgotten your username or password?](#)

## Step 3: Complete your details

Complete or confirm your details, then click **'save'**.

### Welcome to oxfordenglishtesting.com

Welcome to oxfordenglishtesting.com

Our [Privacy Policy](#) sets out how Oxford University Press handles your personal information, and your rights to object to your personal information being used for marketing to you or being processed as part of our business activities.

We will only use your personal information for providing you with this service.

Before starting your placement test, please complete or confirm this information.

First name   
Last name   
Email

oxfordenglishtesting.com says

Confirm save?

## Step 4: Select your test

Click on 'Oxford Placement Test'.

### My tests

My Tests

Results

#### My tests

Click test name to start (Please note: Pop-ups are required to start the test)

#### Status and results

If you have completed your test, and the status is still showing as 'In progress' refresh this page to see your status update. You will then see the message 'You currently do not have access to any tests'.

Alternatively, if a 'Results' tab is visible, navigate to the Results tab to see your status update and view your results. When your results are available the test will show as 'Whole test marked and complete'.

test	Expiry date	Status
<a href="#">Oxford Online Placement Test 11</a>	08/2025 23:59	Not started

## Step 5: Choose your starting level

The test will open in a new window.

First, choose the starting level you want, then click **'next'**.

*(The starting level you choose will not affect your final test score).*



---

Please select your starting difficulty from the options below. The test will begin at this difficulty level, but will automatically adapt based on your performance as the test progresses:

Computer chooses for you

Low

Medium

High

## Step 6: Take the test

Answer all the questions in the time shown on the screen. Good luck!

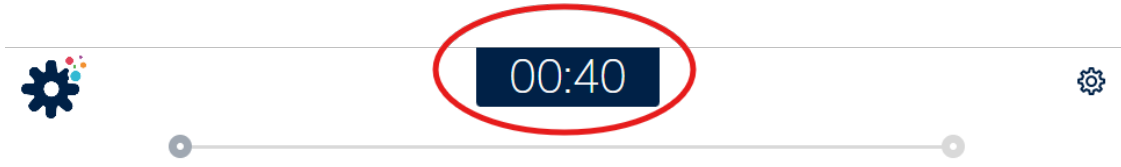

You can adjust the text size and the background colour at any time during the test, using the settings icon in the top right corner of the screen.

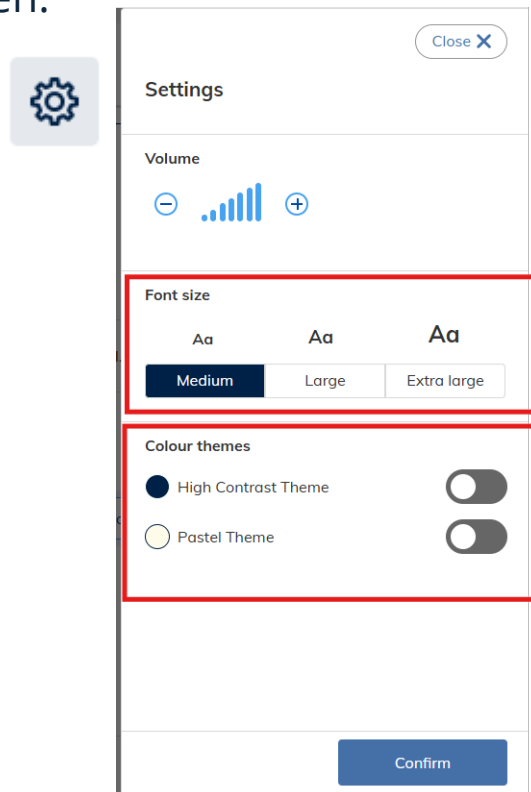

## Step 7: Finishing the test

When you have finished, click the 'Finish' button to submit your answers. You can then close the test window. Then wait to hear from your test administrator.



---

**You have answered all the questions**

Select *Finish* to submit your answers and complete your test

Finish